

Oil Electropump AC, Series: A Oil - Article:OETP0428

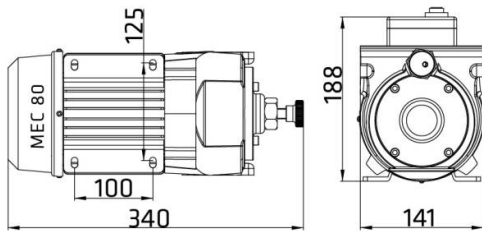
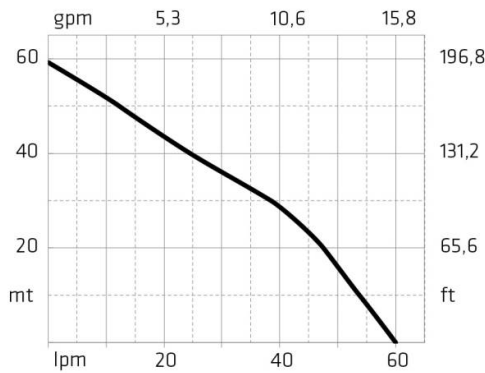

Technical features:

Flow rate (1 bar):	55 lt/min
Voltage:	230V 50Hz
Max Pressure:	6 Bar
IN:	F 1" BSP
OUT:	F 1" BSP
Flange IN-OUT:	Yes
Suction:	3 mt
Self Priming:	Automatic
Integrated filter:	Not included
Motion transmission:	Supported Crankshaft
Type rotor:	6 Vains
Pump Body:	Cast iron
By-pass:	Adjustable
Seal:	10 bar Mechanical seal
Anti flooding motor protection:	Included
Engine Rotation :	2800 rpm
Power:	1491watt (2hp)
Motor Frame:	80 MEC
Ampere:	8 Amp.
Switch ON-OFF:	Not included
Electric Wire:	Not included
Noisiness:	80 db
Operating temperature:	+60 / -10 °C
Packaging:	46x27x36h cm
Weight:	17,3 Kg